

Heatshrinkable moulded shapes bulbous Bottle Shapes, MIL-Style - HellermannTyton

DRAWING No.
152127

SHT. 1
OF
1 SHTS.

© THE COPYRIGHT OF THIS DRAWING IS RESERVED BY HELLERMANN TYTON. IT IS ISSUED ON CONDITION THAT IT IS NOT COPIED, REPRODUCED OR DISCLOSED TO A THIRD PARTY EITHER WHOLLY OR IN PART WITHOUT THE CONSENT IN WRITING OF HELLERMANN TYTON.

THIRD ANGLE PROJECTION

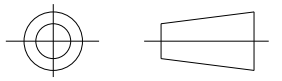

BS 8888

DO NOT SCALE
IF IN DOUBT ASK

Q.A.	H/S SETT
H/S Q.A.	REL. INSP.
H/S PROD	EXT.ISS.CODE 7

STANDARD PART (AFTER UNRESTRICTED RECOVERY)

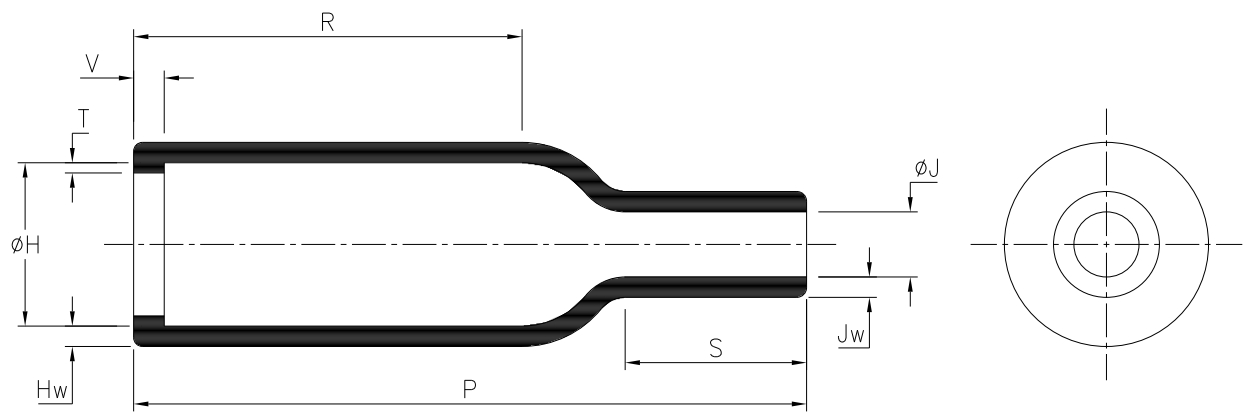

EXPANDED (AS SUPPLIED)

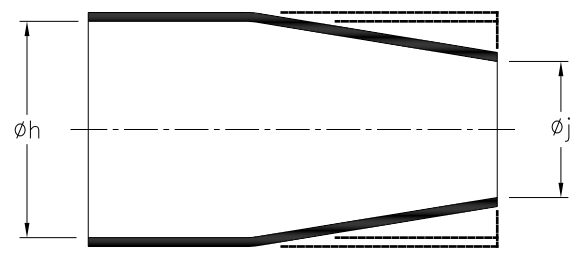

OPTION TO STANDARD PART
FILLER PORT (CODE P1)

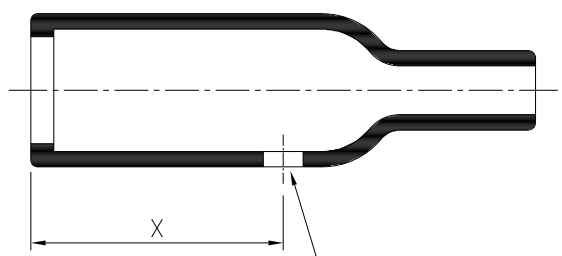

1 FILLER PORT
ø4.5 NOM (.18)

PART No.	EXPANDED DIAMETERS (AS SUPPLIED)		RECOVERED DIAMETERS		RECOVERED DIMENSIONS						
	øh	øj	øH	øJ	P	R	S	T	V	Hw	Jw
	MIN	MIN	MAX	MAX	±10%	NOM	NOM	±20%	MAX	±20%	±20%
113-4	10.7 (.42)	4.6 (.18)	7.9 (.31)	2.0 (.08)	25.4 (1.00)	14.5 (.57)	4.6 (.18)	1.0 (.04)	3.3 (.13)	1.3 (.05)	1.3 (.05)

OPTIONAL FILLER PORT DETAIL	
PART No.	RECOVERED DIMENSIONS
113-4	X
	±10%
113-4	13 (.51)

Heatshrinkable moulded shapes bulbous Bottle Shapes, MIL-Style - HellermannTyton

For information only, not subject to technical changes.

2	P1329	G.B.	11/10/10
1	P1200	S.Almond	09/05/08
ISSUE	NOTE No.	DRAWN	DATE

HellermannTyton

Pennycross Close, Plymouth, Devon, England
Tel ++44 (0) 1752 701261 Fax ++44 (0) 1752 790058

NAME	S.Almond	SCALE	NTS
DATE	09/05/08	DIMS IN	mm (in)
TITLE	BOTTLE SLEEVE (RIBBED)		

ADHESIVE	A3	SHT. 1
	ORIGINAL SHEET SIZE 420mm x 297mm	OF 1 SHTS.
PART No.	113	DRAWING No.
		152127